



NATIONAL CAPITAL COMMISSION
COMMISSION DE LA CAPITALE NATIONALE

Canada Science and Technology Museum

Museum Park – Concept Design

Board of Directors
June 29, 2017



Project Overview

The Canada Science and Technology Museum (CSTM) is proposing to build a world-class Museum Park on its campus.

The Museum Park will offer visitors a variety of play experiences that encourage free play for all ages, empower children to learn through play and transform an ordinary green space into a park that is unparalleled in the region.

Project Context

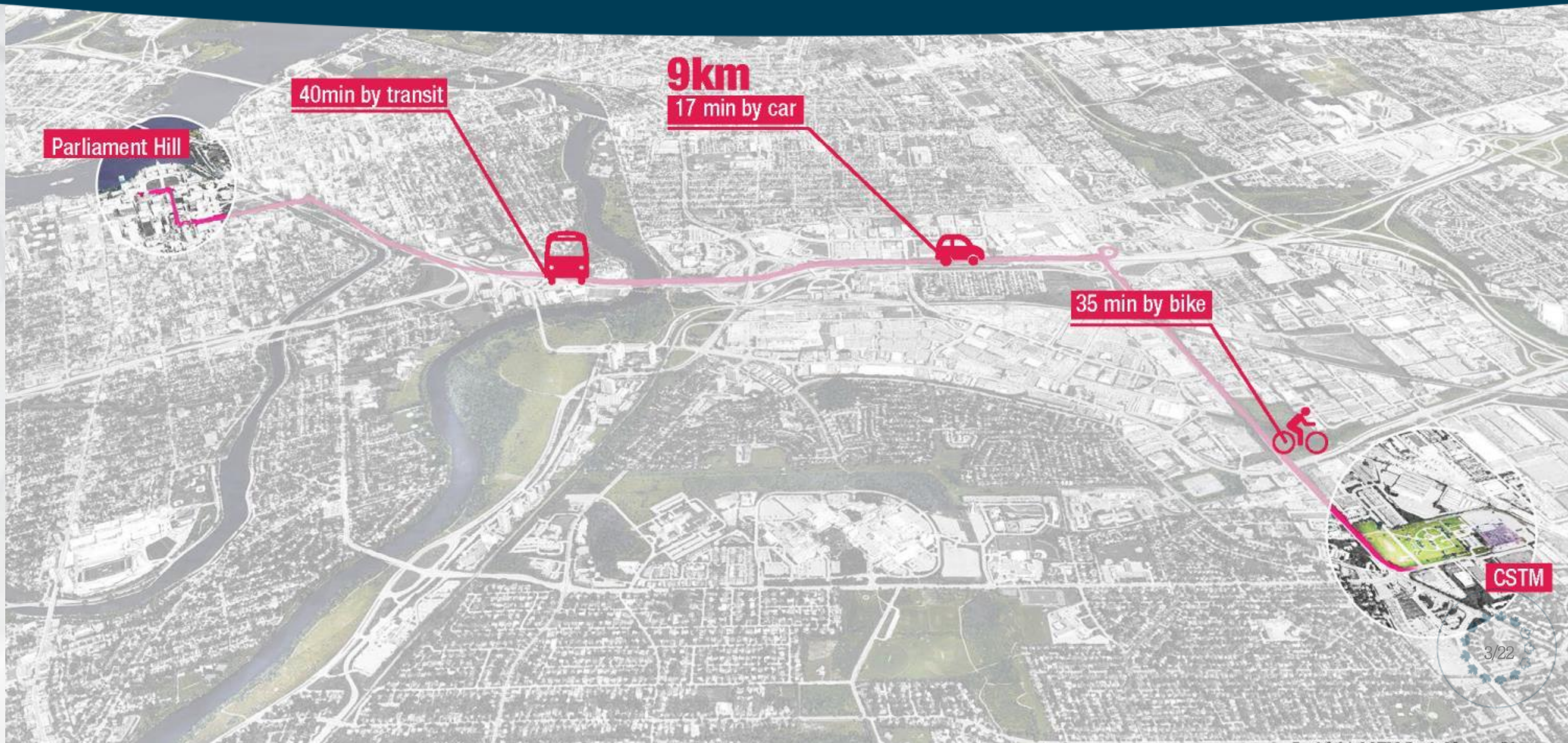

CSTM

3/22

Project Context

STUDY AREA

C3 Building

New Museum

4.2 hectares

4/22

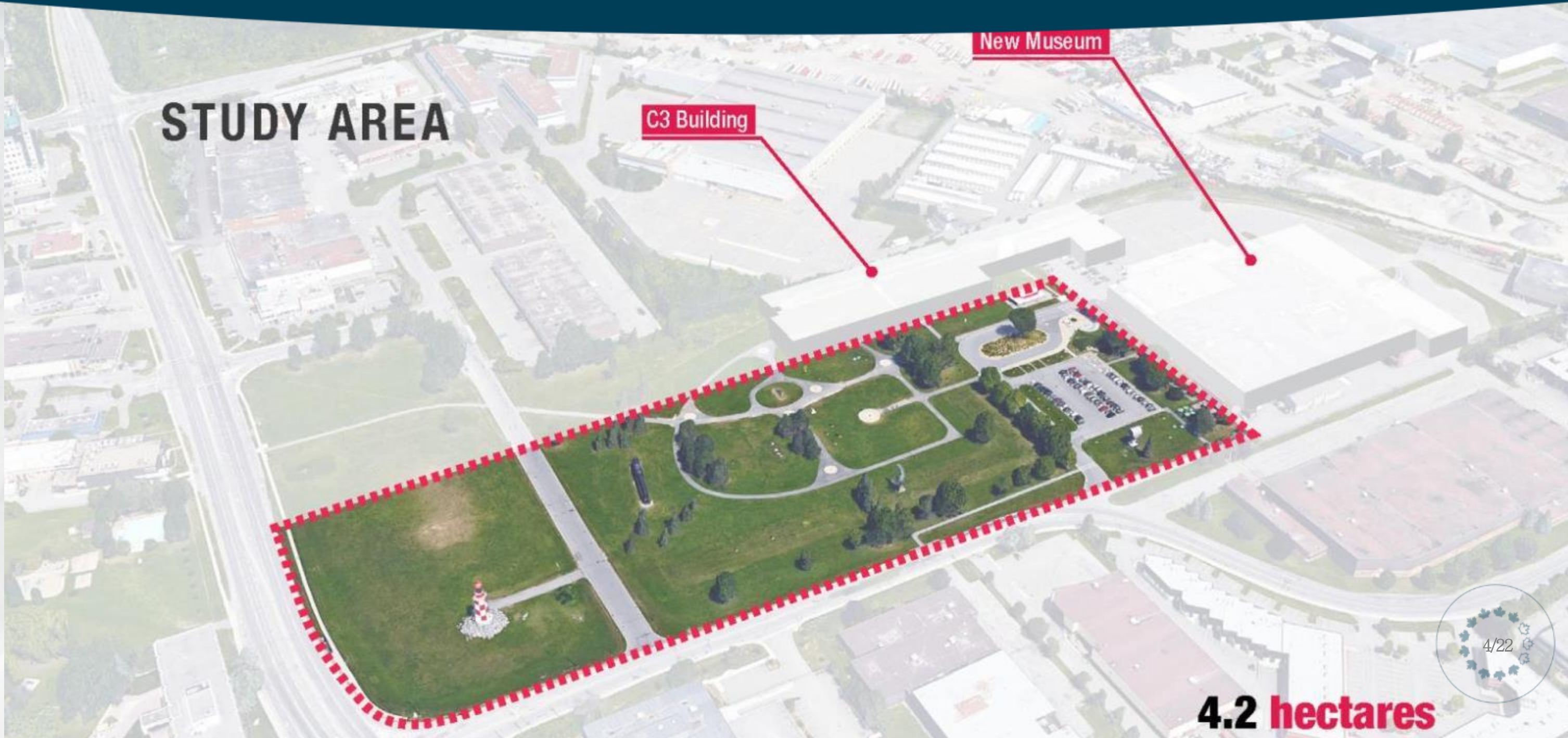

Engagement and Consultation

ENGAGEMENT PROCESS



WHAT WE HEARD SUMMARY

- Safety, Inclusivity, and Accessibility
- Multi-use / Flexible Urbanism
- Place-making
- All Seasons
- Learning through Play
- Linking back to the Community
- Sustainability

Design Evolution

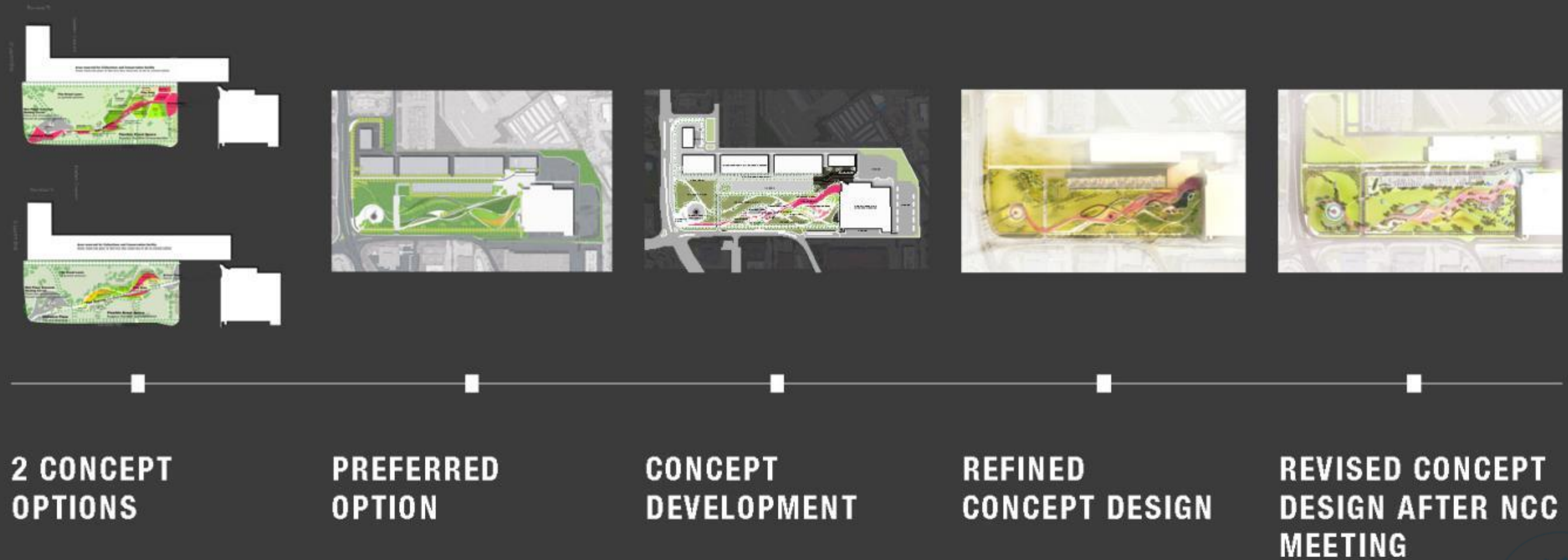

NCC Comments

WHAT WE HEARD

Improve
north-south
connections

Enhance
urban forest

Clarify
pedestrian
and vehicular
circulation

Improve
transition from
curvilinear to
rectilinear style

Develop Flex
Event Space

Improve crossings
with raised
crosswalks and
coloured paving

Provide more
passive spaces

Show attention to
edge conditions

Concept Design

REVISED PLAN



Circulation

- 3 Plan for circulation types (The skateboard route is separated from the primary pathways)**

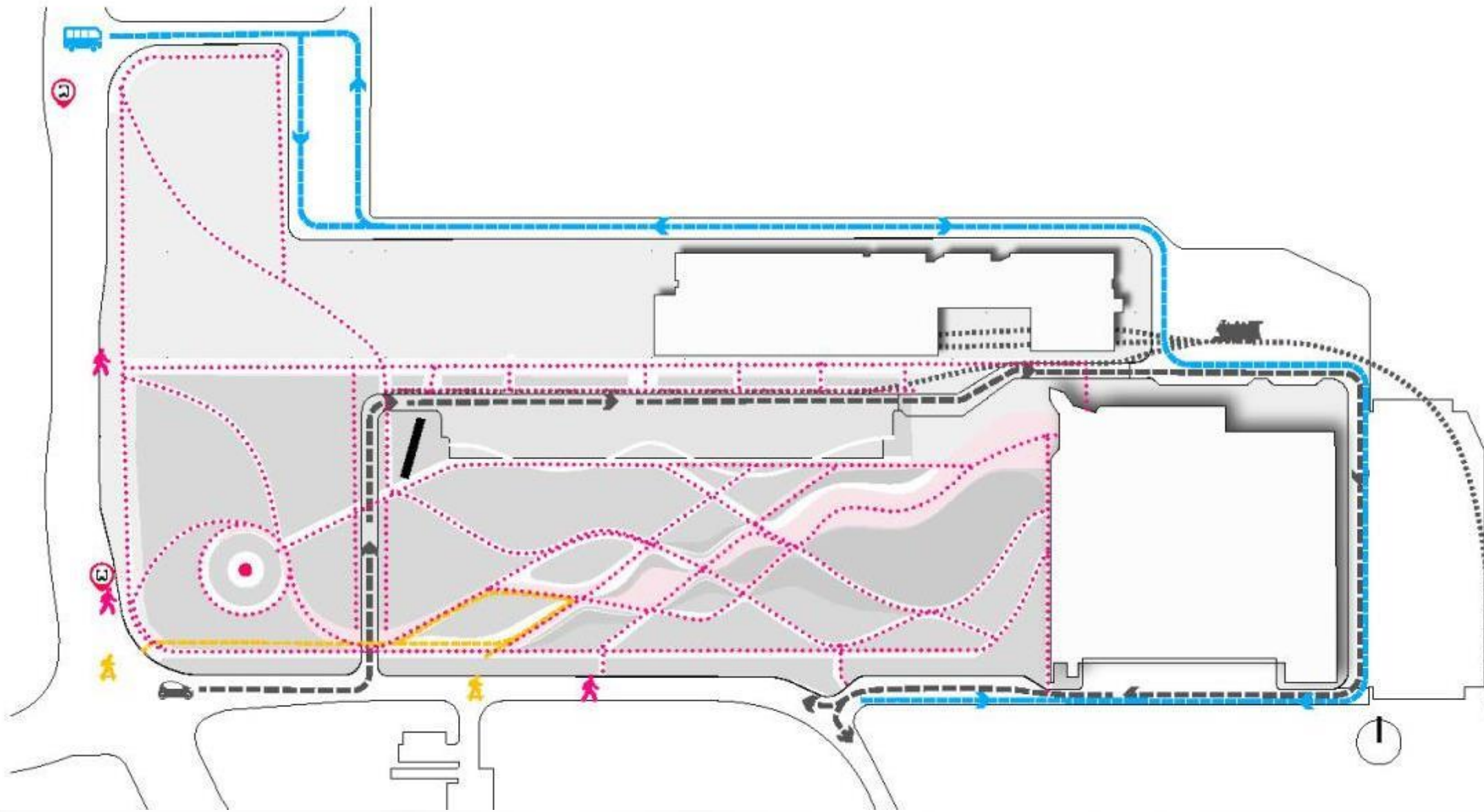

Circulation

Points of interests along the way...

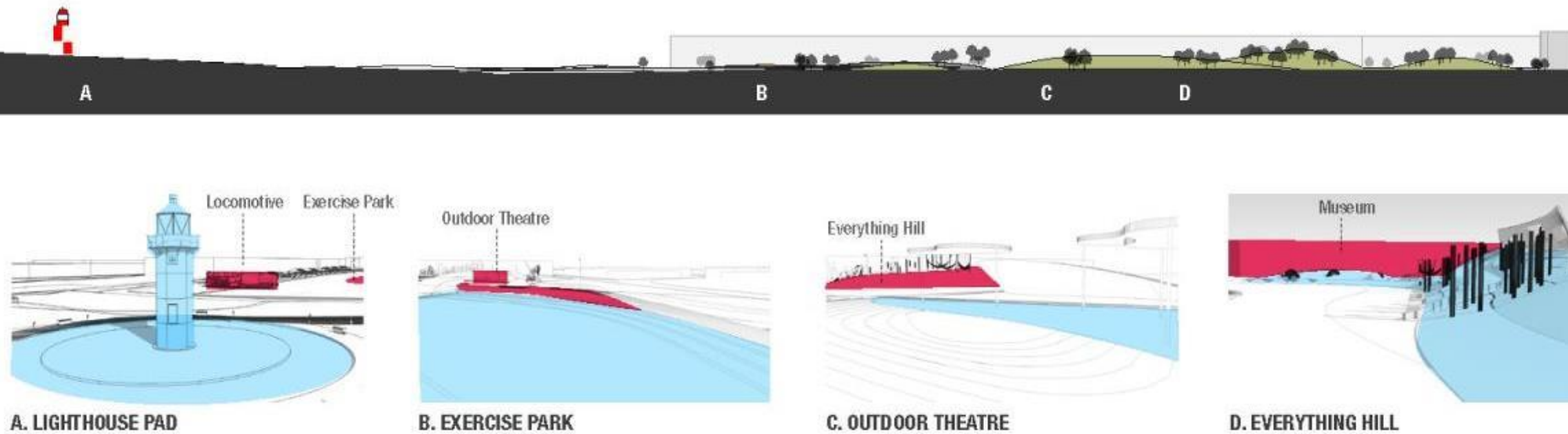

Project Details

LIGHTHOUSE PAD



Project Details



Project Details

FLEX EVENT SPACE



Project Details

CURIOSITY WAY



Project Details



Project Details

EVERYTHING HILL

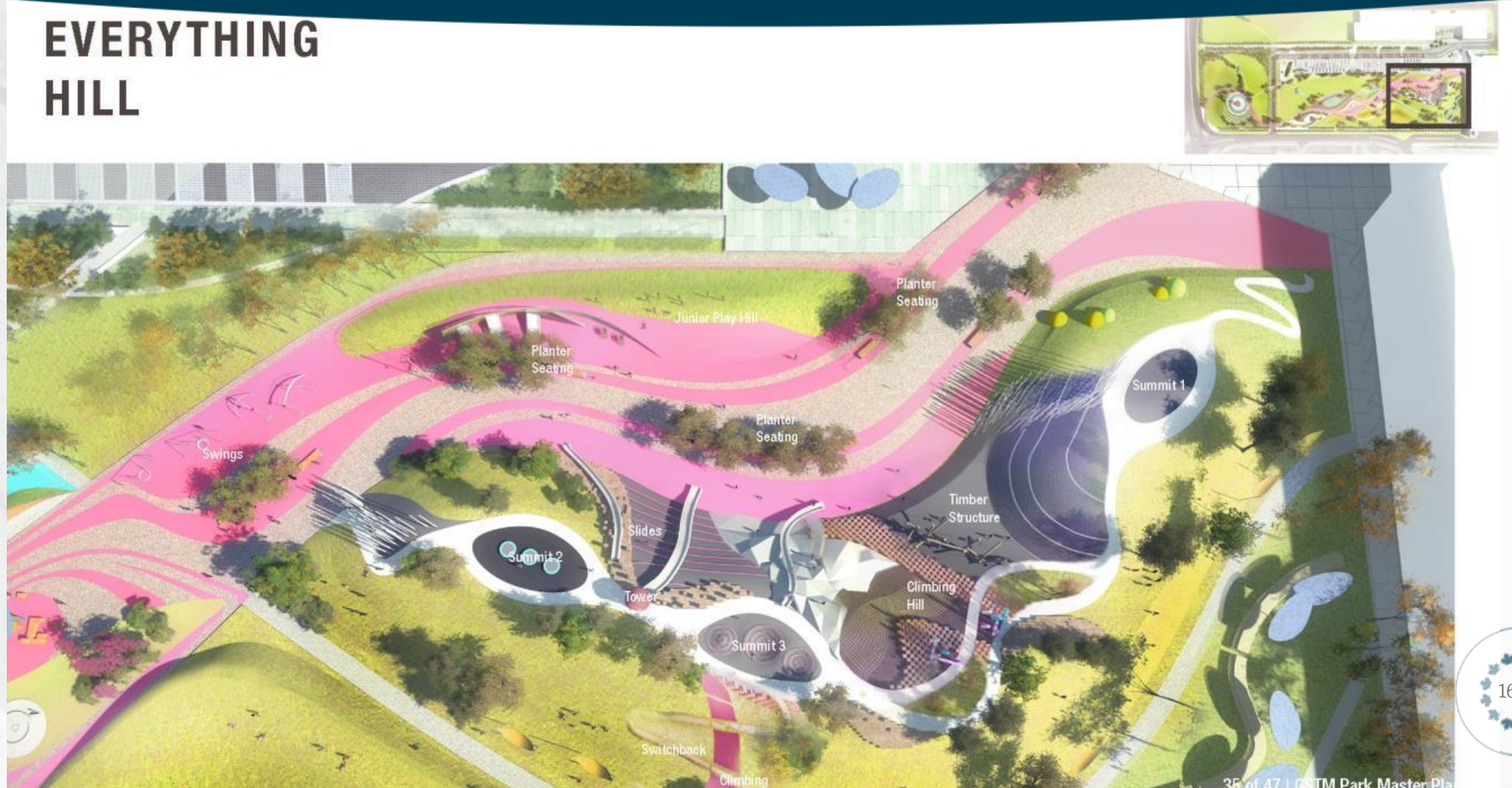

Project Details

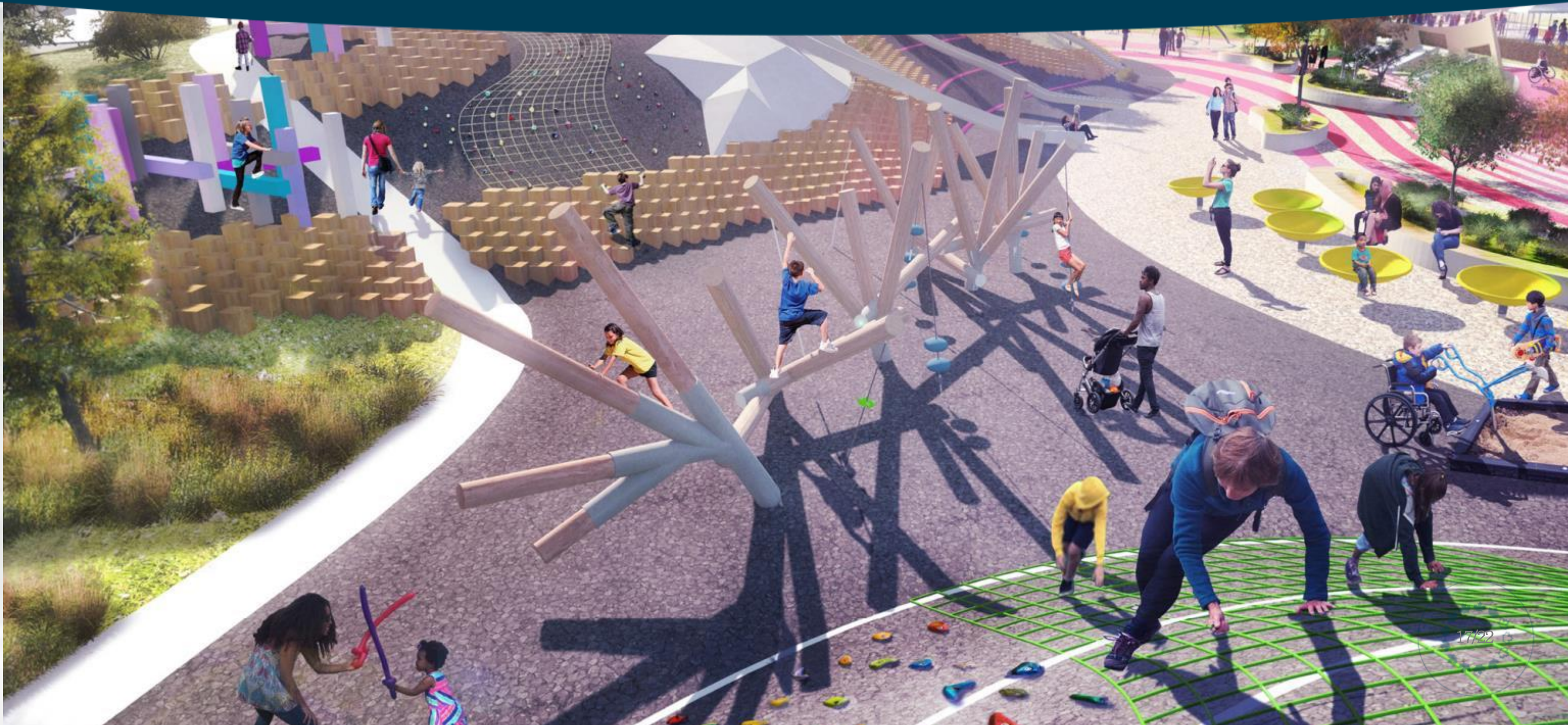

Project Details

LIGHTING PLAN

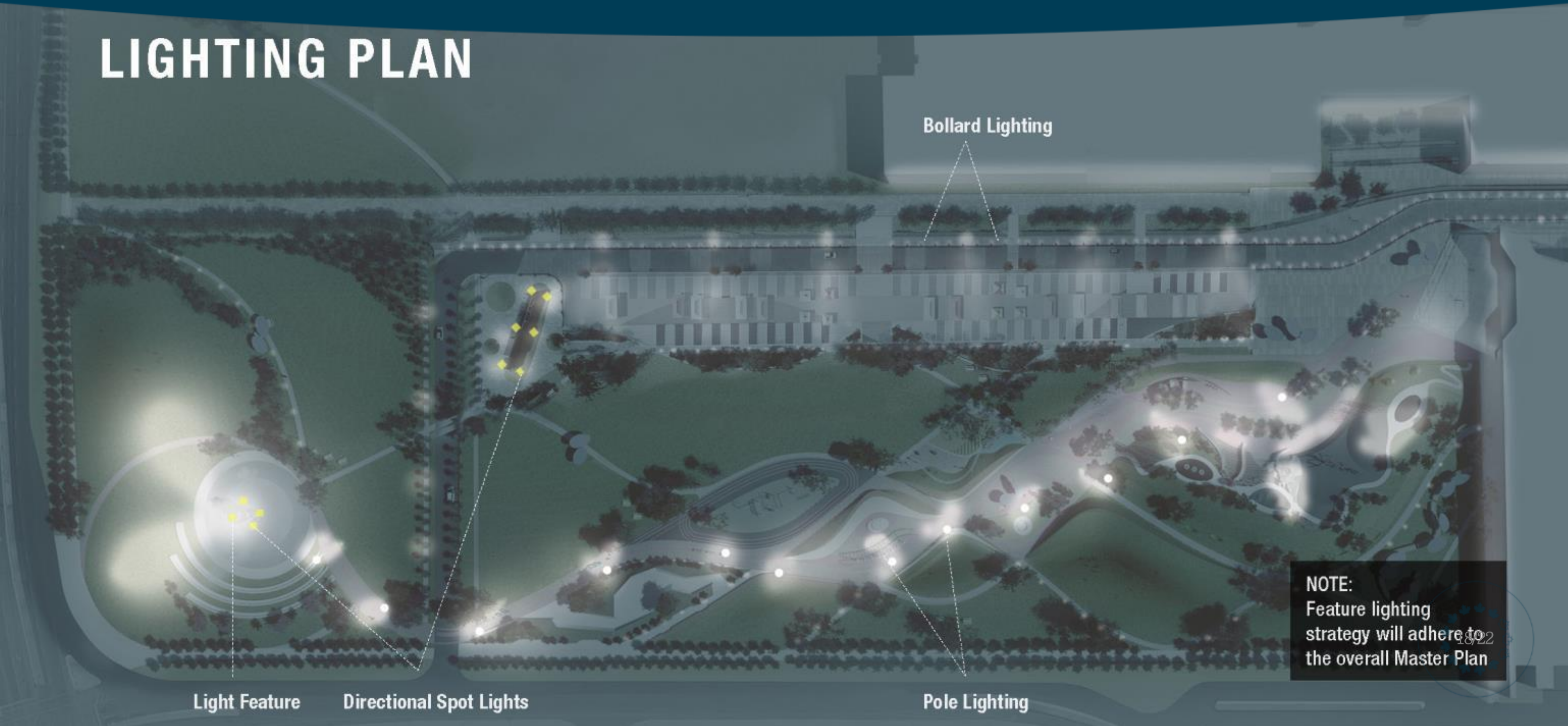

Bollard Lighting

Light Feature

Directional Spot Lights

Pole Lighting

NOTE:
Feature lighting
strategy will adhere to
the overall Master Plan

18/22

Program

SEASONAL USE - SUMMER ACTIVITIES



Program

SEASONAL USE - WINTER ACTIVITIES

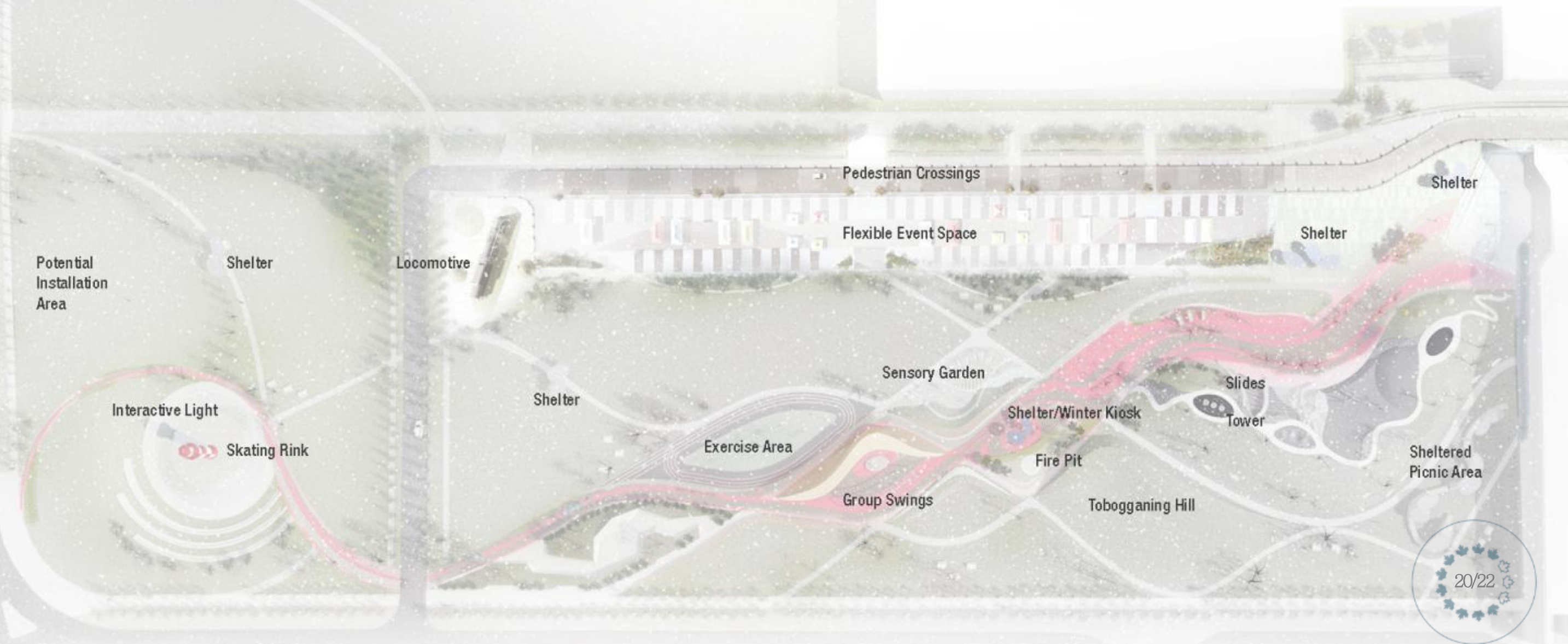

Recommendation

THAT the Federal Land Use and Design Approval for the Concept Design of the Museum Park for the Science and Technology Museum site be granted subject to further design development, taking into account NCC staff and ACPDR comments, before returning to the Board of Directors for Federal Land Use and Design Approval for the Final Design.

THAT the preparation and signature of the Federal Land Use and Design Approval document for the Concept Design of the Museum Park for the Canada Science and Technology Museum site be delegated to the Executive Director, Capital Planning Branch.



Thank you